

新潤興業股份有限公司

SHIN RUENN DEVELOPMENT CO., LTD

2024年 法人說明會
2024 Investor Conference



股票代號：6186
Stock Code：6186

免責聲明

Disclaimer Statement

- 本簡報及同時發佈之相關訊息內含有從公司內部與外部來源所取得的預測性資訊，其中包括營運展望、財務狀況以及業務預測等內容。
- 本公司未來實際所發生的營運結果、財務狀況以及業務展望，可能與這些預測性資訊所明示或暗示的預估有所差異。其原因可能來自於各種因素，包括但不限於市場需求、價格波動、競爭情勢、國際經濟狀況、供應鏈、匯率波動以及其他本公司所不能掌控的風險等因素。
- 本簡報中對未來的展望，反應本公司截至目前為止對於未來的看法。對於這些看法，未來若有任何變更或調整時，本公司並不負責隨時提醒或更新。
- This presentation and accompanying materials contain "forward-looking statements," which may include projections regarding future operational results, financial conditions, or business prospects, based on information currently available to us and other sources.
- Actual operational results, financial conditions, or business prospects may differ significantly from those expressed or implied in these forward-looking statements due to various factors. These include, but are not limited to, changes in market demand, price fluctuations, competitive dynamics, international economic conditions, supply chain disruptions, exchange rate volatility, and other risks or factors beyond our control.
- The forward-looking statements presented herein represent the views and assumptions of Continental Holdings Corporation as of the date of this release. Continental Holdings Corporation assumes no obligation to update or revise these forward-looking statements in light of subsequent events or circumstances.

議程 Agenda

1. 公司簡介
Company Profile

2. 財務概況
Financial Information

3. 營運概況
Business Activities

4. 未來展望
Prospects

5. 提問答覆
Q&A

公司簡介

Company Profile

- 沿革：1998年3月30日設立
2011年7月27日更名「新潤興業股份有限公司」轉型建設業
- 股票代號：6186
- 實收資本額：新台幣17.2億
- 董事長：郭長庚
- 發言人：蔣秀婷
- 總部：臺北市松山區民生東路三段109號8樓
- 網站：<http://www.shinruenn.com>
- 產業：營造建設、不動產開發
- 產品：住宅大樓、商業大樓
- Established：March 30, 1998
July 27, 2011: Renamed as "Shin Ruenn Development Co., Ltd." and transitioned into the construction industry.
- Stock Code：6186
- Capital：NTD 1.72 billion
- Chairman：Kuo, Chang-Keng
- Spokesperson：Chiang, Hsiu-Ting
- Head Office：8F., No.109, Sec.3, Minsheng E. Rd., Songshan Dist., Taipei City 105, Taiwan(R.O.C)
- Website：<http://www.shinruenn.com>
- Industry：Construction, Real Estate Development
- Product：Residential/Commercial Mixed-Use buildings

財務概況

Financial Information

1. 經營實績

Business Performance

2. 財務績效與指標

Financial Performance and Metrics

3. 股利政策

Dividend Policy

經營實績

Business Performance

損益 Income Statement	113/1/1~9/30 2024/1/1~9/30		112/1/1~9/30 2023/1/1~9/30	
項目 Item	金額 Amount	比率% Ratio	金額 Amount	比率% Ratio
營業收入 Operating Revenue	4,634,141	100%	1,036,144	100%
營業成本 Operating Cost	(3,815,563)	82%	(741,072)	72%
營業毛利 Gross profit	818,578	18%	295,072	28%
營業利益 Net Operating Income	445,704	10%	157,312	15%
稅前淨利 Profit Before Income Tax	463,141	10%	159,154	15%
基本每股盈餘 EPS	2.14		0.75	

單位：仟元
Unit : NTD thousand

經營實績

Business Performance

資產負債及權益 Assets, Liabilities, and Equity		113Q3 2024 Q3		112Q4 2023 Q4		112Q3 2023 Q3	
項目 Item	金額 Amount	比率% Ratio	金額 Amount	比率% Ratio	金額 Amount	比率% Ratio	
現金及約當現金 Cash and Cash Equivalents	1,076,242	5%	426,937	2%	445,765	2%	
存貨 Inventories	16,960,907	78%	16,303,335	82%	17,202,005	84%	
流動資產合計 Total Current Assets	20,782,082	96%	19,305,213	97%	19,894,469	97%	
資產總計 Total assets	21,695,627	100%	19,806,980	100%	20,533,546	100%	
流動負債合計 Total Current Liabilities	16,596,960	77%	15,573,839	79%	16,314,452	79%	
負債總計 Total liabilities	18,430,493	85%	16,610,250	84%	17,653,544	86%	
普通股股本 Ordinary Share Capital	1,724,846	8%	1,499,861	8%	1,499,861	7%	
權益總計 Total Equity	3,265,134	15%	3,196,730	16%	2,880,002	14%	

單位：仟元
Unit：NTD thousand

經營實績

Business Performance

現金流量項目 Statement of Cash Flows	113 Q3 2024 Q3	112 Q3 2023 Q3
營業活動之淨現金流入(流出) Net cash inflow from operating activities(outflow)	302,938	(981,032)
投資活動之淨現金流出 Net cash outflow from investing activities	(674,602)	(277,037)
籌資活動之淨現金流入 Net cash inflow from financing activities	1,020,969	1,277,074
本期現金及約當現金增加數 Increase in cash and cash equivalents for the current period	649,305	19,005
期初現金及約當現金餘額 Beginning cash and cash equivalent balances	426,937	426,760
期末現金及約當現金餘額 Ending cash and equivalent cash balances	1,076,242	445,765

單位：仟元
Unit：NTD thousand

財務績效與指標

Financial Performance and Metrics

年度 (Year) 損益項目 (Item)	108年 2019	109年 2020	110年 2021	111年 2022	112 2023	113年Q3 2024/Q3
營業收入 Operating Revenue	2,790,647	2,855,814	3,975,007	2,491,435	3,657,467	4,634,141
營業毛利 Gross Profit	806,624	805,552	820,905	703,402	905,069	818,578
營業費用 Operating Expenses	363,158	321,805	263,652	295,645	353,908	372,874
營業利益 Net Operating Income	443,466	483,747	557,253	407,757	551,161	445,704
稅前淨利 Profit Before Income Tax	432,171	483,668	558,533	411,348	557,128	463,141
稅後淨利 Net Income	420,938	381,373	420,321	327,248	445,710	368,376
每股盈餘 EPS	4.21	3.28	3.08	2.24	2.97	2.14

單位：新台幣元（除稅後每股盈餘及股利為新台幣元）Unit：NTD（EPS：NTD/Per Share）

財務績效與指標

Financial Performance and Metrics

單位：仟元
Unit : NTD thousand

資產負債項目 Balance sheet	108年度 2019	109年度 2020	110年度 2021	111年度 2022	112年度 2023	113年Q3 2024 Q3
流動資產 Current Assets	8,494,285	14,715,541	15,042,396	17,196,436	19,305,213	20,782,082
其他資產 Other Assets	990,623	873,494	569,003	719,814	482,329	892,699
資產總額 Total Assets	9,558,064	15,661,147	15,619,121	17,921,267	19,806,980	21,695,627
流動負債 Current Liabilities	5,659,057	10,941,953	11,145,871	13,239,344	15,573,839	16,596,960
非流動負債 Non-current Liabilities	2,110,157	2,105,225	1,600,128	1,600,933	1,036,411	1,833,533
負債總額 Total Liabilities	7,769,214	13,047,178	12,745,999	14,840,277	16,610,250	18,430,493
股本 Share Capital	1,000,344	1,300,344	1,365,361	1,499,861	1,499,861	1,724,846
資本公積 Capital Surplus	209,637	651,452	651,452	847,530	847,530	847,530
保留盈餘 EPS	578,869	660,139	856,309	733,599	849,339	692,758
權益總額 Total Equity	1,788,850	2,613,969	2,873,122	3,080,990	3,196,730	3,265,134

財務績效與指標

Financial Performance and Metrics

單位：仟元
Unit : NTD thousand

項目 Item	108年度 2019	109年度 2020	110年度 2021	111年度 2022	112年度 2023	113年 03 2024 Q3
負債佔資產比率 (%) Liabilities to assets ratio (%)	81.28	83.31	81.61	82.81	83.86	84.95
流動比率 (%) Current ratio(%)	150.1	134.49	134.96	129.89	123.96	125.22
資產報酬率 (%) Return on Assets(%)	5.66	3.07	2.71	1.95	2.36	1.78
權益報酬率 (%) Return on equity(%)	25.85	17.32	15.32	10.99	14.20	11.40
稅前純益佔實收資本額比率 (%) Ratio of net income before tax to paid-in capital (%)	43.2	37.2	40.81	27.43	37.15	26.85
純益率 (%) Net profit margin(%)	15.08	13.35	10.57	13.13	12.19	7.95
每股盈餘 (元) EPS	4.21	3.45	3.08	2.24	2.97	2.14

股利政策

Dividend Policy

■ 現金股利 ■ 股票股利

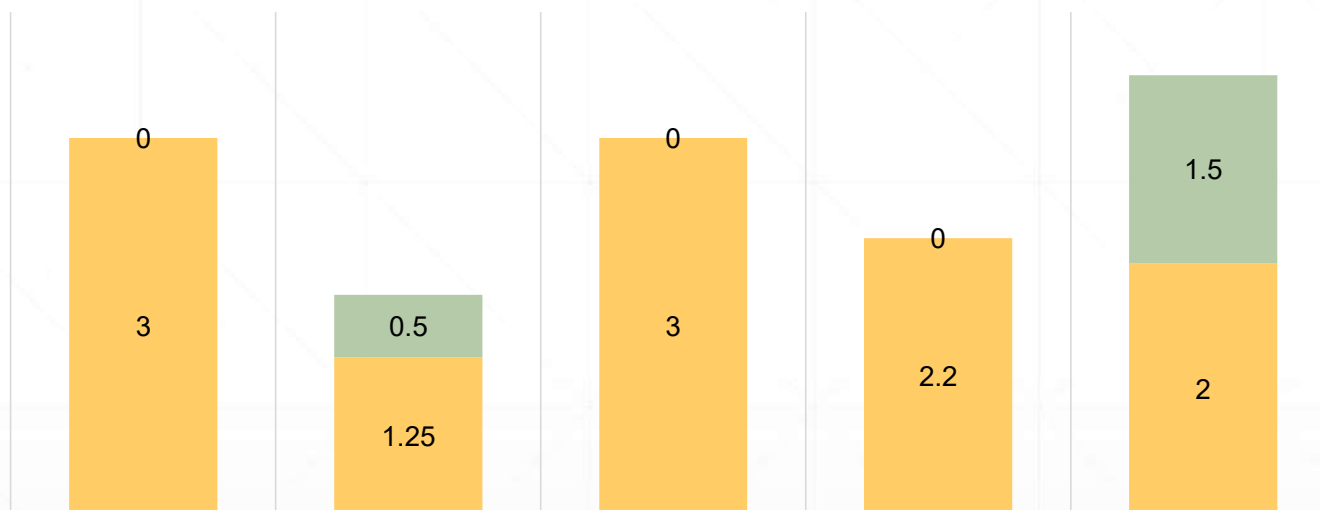

股利所屬期間Year	2019	2020	2021	2022	2023
現金股利Cash Dividend	3.00	1.25	3.00	2.2	2.0
股票股利Stock Dividend	0.00	0.50	0.00	0	1.5
現金殖利率Cash Dividend Yield	8.72%	4.19%	10.6%	4.26%	1.79%

每股盈餘與股利分派情形

Earnings per Share and Dividend Distribution

項目 Item	108年度 2019	109年度 2020	110年度 2021	111年度 2022	112年度 2023	113年度 Q3 2024 Q3
股本(仟元) Share Capital (NTD thousand)	1,000,344	1,300,344	1,365,361	1,499,861	1,499,861	1,724,846
每股盈餘(元) EPS	4.21	3.45	3.08	2.24	2.97	2.14
現金股利 Cash Dividend	3.00	1.25	3.00	2.2	2.0	-
股票股利 Stock Dividend	0.00	0.50	0.00	0	1.5	-
股利合計 Total Dividend	3.00	1.75	3	2.2	3.5	-

股利分派率

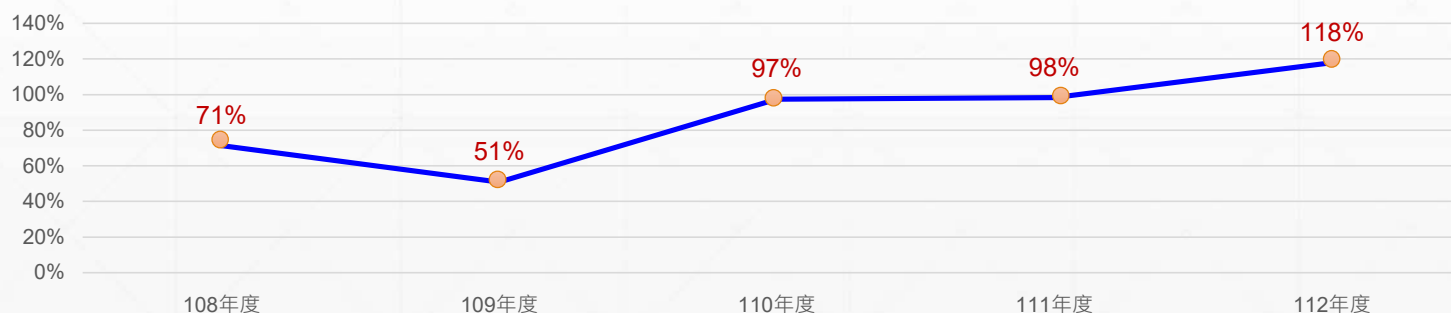

營運概況

Business Activities

1. 銷售個案

Ongoing Pre-sale Projects

2. 2024完工個案

Construction Projects Completed in 2023

3. 企業社會責任

Corporate Social Responsibility

銷售個案

Ongoing Pre-sale Projects

序號 No.	建案名稱 Projects	區域 Area	全案戶數 Total units	總銷金額(億元) Total amount in sales(NT\$100 million) 僅列新潤自佔總銷 Only Shinruenn's profit is listed	銷售率 Sales rate
1	新潤RIVER ONE RIVER ONE	新北市板橋區 Banqiao Dist, New Taipei City	259	38	100%
2	新莊新知商辦 Xinzhi commercial	新北市 新莊區 Xinzhuang Dist, New Taipei City	32	29.9	100%
3	新潤A5 Metro A5	新北市 泰山區 Taishan Dist, New Taipei City	320	25.92	100%
4	新潤麗蒔 Boutique Casa	桃園市 蘆竹區 Luzhu Dist, Taoyuan City	324	15.18	100%
5	明日莊園 The Manor House	桃園市 大園區 Dayuan Dist, Taoyuan City	69	12.69	100%
6	擎天森林 Sky Forest	台北市 南港區 Nangang Dist, Taipei City	400	54.6	99.8%
7	新潤青樺 Seasons Park	新北市土城區 Tucheng Dist, New Taipei City	299	39	99%
8	森中央 MORI CENTRAL TOWER	新北市 新莊區 Xinzhuang Dist, New Taipei City	339	21	63%
9	士科大院. LA MOON CITY SPIRIT	台北市 北投區 Beitou Dist, Taipei City	256	77	4月推出 Launched at Apr.
總 計			2,253	313.29	

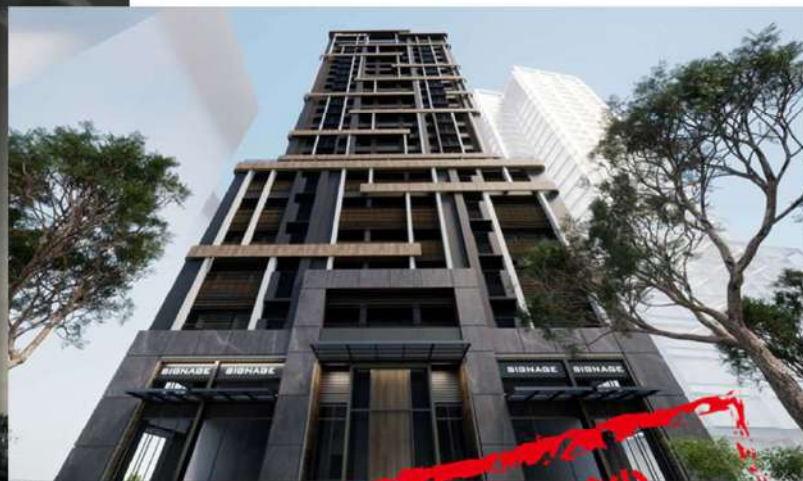
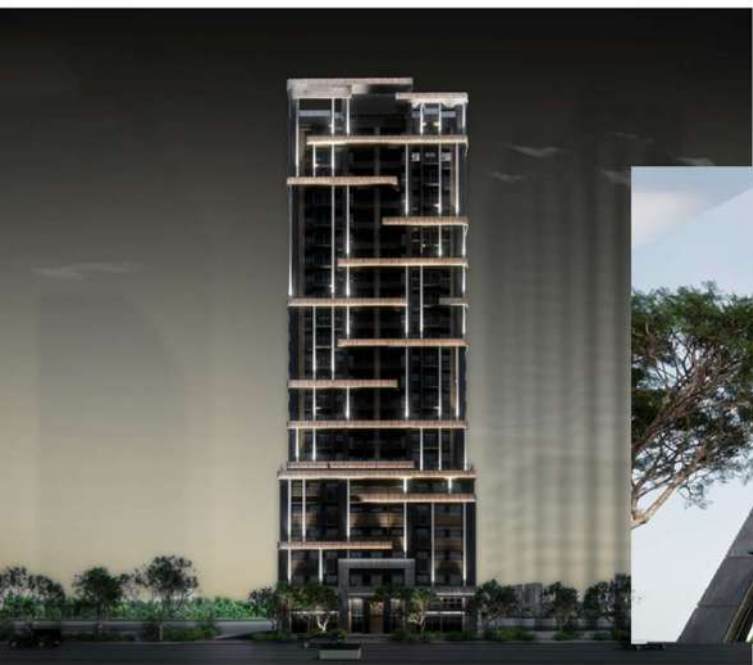

完銷
SOLD OUT

新北市板橋區 RIVER ONE

Banqiao Dist, New Taipei City RIVER ONE

RIVER ONE

基地位置 Location	環河西路四段與華江九路旁 At the intersection of Sec. 4, Huanhe W. Rd., and Huajiang 9th Rd., Banqiao Dist., New Taipei City
基地面積 Base Area	839.37坪 about 839.37 ping
戶數 Unit	259戶(全案) 259 Residential Units(whole project)
規劃設計 Architectural Design	地上24層/地下4層 24 stories above ground/ 4 stories below round
總銷 Total Amount	38億(僅列新潤部份) NTD 3.8 billion (only Shinruenn's profit is listed)

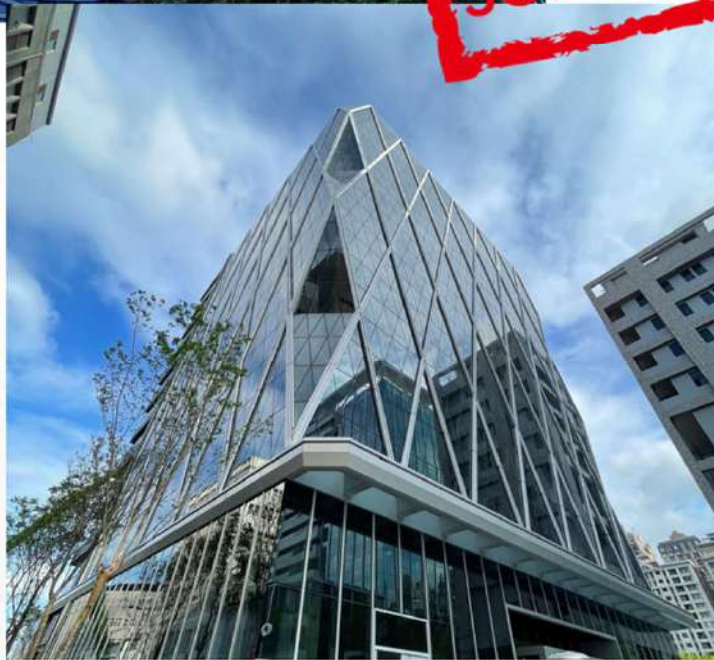

完銷
SOLD OUT

新北市新莊區 新知商辦

Xinzhuang Dist, New Taipei City Xinzhi commercial

基地位置 Location	新莊區新知八路28號 No. 28, Xinzhi 8th Rd., Xinzhuang Dist., New Taipei City
基地面積 Base Area	907.5坪 about 907.5 ping
戶數 Unit	32戶(全案) 32 Units(whole project)
規劃設計 Architectural Design	地上11層/地下3層 11 stories above ground/ 3 stories below round
總銷 Total Amount	29.9億(僅列新潤部份) NTD 2.99 billion (only Shinruenn's profit is listed)



完銷
SOLD OUT

新北市 泰山區 新潤A5

Taishan Dist, New Taipei City METRO A5

新潤A5

基地位置
Location 泰山區泰林路一段29號旁
Beside No. 29, Sec. 1, Tailin Rd.,
Taishan Dist., New Taipei City

基地面積
Base Area 1338坪
about 1338 ping

戶數
Unit 320戶(全案)
320 Residential Units (whole project)

規劃設計
Architectural Design 地上20層/地下5層
20 stories above ground/
5 stories below ground

總銷
Total Amount 25.92億
NTD 2.592 billion





桃園市蘆竹區 新潤麗詩

Luzhu Dist, Taoyuan City Boutique Casa



完銷
SOLD OUT



基地位置 Location	桃園市蘆竹區機捷路二段 Sec. 2, Jijie Rd., Luzhu Dist., Taoyuan City
基地面積 Base Area	899.95坪 about 899.95 ping
戶數 Unit	324戶(全案) 324 Residential Units (whole project)
規劃設計 Architectural Design	地上11層/地下5層 11 stories above ground/ 5 stories below ground
總銷 Total Amount	15億(僅列新潤部份) NTD 1.5 billion (only Shinruenn's profit is listed)



桃園市大園區 明日莊園

Dayuan Dist, Taoyuan City The Manor House



完銷
SOLD OUT



- 基地位置 Location 桃園市大園區科一街
Ke 1st St., Dayuan Dist., Taoyuan City
- 基地面積 Base Area 1902.55坪
about 1902.55 ping
- 戶數 Unit 69戶(全案)
69 Residential Units(whole project)
- 規劃設計 Architectural Design 地上4層/地下1層
4 stories above ground/
1 stories below ground
- 總銷 Total Amount 12.69億
NTD 1.269 billion





人生該有的高度 樹海裡的地標

南港繼起最繁華核心，是時候用高度和矚目保持距離，26層雙塔地標，一座長在樹海裡的森林秘境，立面垂直俐落延展，弧形圓台格柵細節點睛，坐擁磅礴基地盛大量體，眼界彰顯身價，抬眼山水會卷舒心，看看腳下的城市在說些什麼，富裕雍容不解釋。

台北市南港區 擎天森林

Nangang Dist, Taipei City Sky Forest



擎天森林
SKY FOREST

基地位置	台北市南港區興南街89號
Location	No.89, Xingnan St., Nangang Dist., Taipei City
基地面積	1813坪
Base Area	about 1813 ping
戶數	400戶(全案)
Unit	400 Residential Units(whole project)
規劃設計	地上26層/地下4層
Architectural Design	26 stories above ground/ 4 stories below ground
總銷	54.6億(僅列新潤部份)
Total Amount	NTD 5.46 billion (only Shinruenn's profit is listed)





新北市土城區 新潤青樺

Tucheng Dist, New Taipei City Seasons Park

新潤青樺

SEASONS PARK

基地位置 Location	新北市土城區金城路一段 Sec. 1, Jincheng Rd., Tucheng Dist., New Taipei City
基地面積 Base Area	1563坪 about 1563 ping
戶數 Unit	299戶(全案) 299 Residential Units(whole project)
規劃設計 Architectural Design	地上15層/地下4層 15 stories above ground/ 4 stories below ground
總銷 Total Amount	39億(僅列新潤部份) NTD 3.9 billion (only Shinruenn's profit is listed)





新北市新莊區 森中央

Xinzhuang Dist, New Taipei City
MORI CENTRAL TOWER



基地位置
Location

新北市新莊區富貴路、昌仁路口
at the crossroads Fugui Rd. and
Changren Rd., Xinzhuang Dist., New
Taipei City

基地面積
Base Area

2117坪
about 2117 ping

戶數
Unit

339戶(全案)
339 Residential Units(whole project)

規劃設計
Architectural
Design

住宅地上23層、商辦地上15層
地下5層
Residential 23 stories above ground
Commercial 15 stories above ground
5 stories below ground

總銷
Total Amount

21億(僅列新潤部份)
NTD 2.1 billion
(only Shinruenn's profit is listed)





台北市北投區 LA MOON CITY SPIRIT
Banqiao Dist, New Taipei City RIVER ONE



士科大院

基地位置
Location

台北市北投區洲美街122號對面
Opposite No. 122, Zhoumei St.,
Beitou Dist., Taipei City

基地面積
Base Area

1929坪
about 1929 ping

戶數
Unit

256戶(全案)
256 Residential Units(whole project)

規劃設計
Architectural
Design

地上22層/地下5層
22 stories above ground/
5 stories below round

總銷
Total Amount

77億(僅列新潤部份)
NTD 7.7 billion
(only Shinruenn's profit is listed)



台北市 Taipei City

北投區 士科大院

Beitou Dist, LA MOON CITY SPIRIT

南港區 擎天森林

Nangang Dist, Sky Forest



▲擎天森林/Sky Forest



▲士科大院/LA MOON CITY SPIRIT



桃園市 Taoyuan City

大園區

Dayuan Dist,

蘆竹區

Luzhu Dist,

明日莊園

The Manor House

新潤麗詩

Boutique Casa



新北市 New Taipei City

新莊區

Xinzhuang Dist,

土城區

Tucheng Dist,

板橋區

Banqiao Dist,

新莊區

Xinzhuang Dist,

泰山區

Taishan Dist,

森中央

MORI CENTRAL TOWER

新潤青樺

Seasons Park

新潤RIVER ONE

RIVER ONE

新知商辦

Xinzhi commercial

新潤A5

METRO A5



▲森中央/MORI CENTRAL TOWER



▲新潤青樺/Seasons Park



▲新潤RIVER ONE



▲新知商辦/Xinzhi commercial



▲新潤A5/METRO A5

2024完工個案

Construction Projects Completed in 2024

序號 No.	建案名稱 Projects	區域 Area	戶數 Total units	總銷金額(億元) Total amount in sales (NT\$100 million) 僅列新潤自佔總銷 Only Shinruenn's profit is listed	銷售率 Sales rate
1	新潤A5 Metro A5	新北市 泰山區 Taishan Dist, New Taipei City	320	25.92	100%
2	新潤心苑 The Fancy World	新北市 淡水區 Danshui Dist, New Taipei City	98	9.55	100%
3	新莊新知商辦 Xinzhi commercial	新北市 新莊區 Xinzhuang Dist, New Taipei City	32	29.9	100%
4	新潤麗蒔 Boutique Casa	桃園市 蘆竹區 Luzhu Dist, Taoyuan City	324	15.18	100%
合計 Total				80.55	

※ 完工意指取得使用執照，不代表入帳認列比例

※ Completion refers to obtaining the usage license and does not indicate the percentage recognized in accounting.

企業社會責任

Corporate Social Responsibility

新潤興業自成立以來，秉持初衷，用感恩、奉獻與回饋的經營理念，十多年來積極投身愛心公益、不忘企業社會使命，長期幫助偏鄉兒童、不便長者、寒士街友等弱勢團體，都是公司持續行善的對象。

Shin Ruenn has remained true to its founding purpose since its establishment, operating under a business philosophy of gratitude, dedication, and giving back. For over a decade, the company has actively engaged in charitable activities, upholding its social mission by supporting disadvantaged groups such as children in rural areas, vulnerable elderly individuals, the homeless, and others in need of assistance.



珍惜水資源 健走活動

Cherishing Water Resources - 5K Walkathon

為了讓更多人知道水資源的珍貴，新潤興業與蒲公英希望基金會共同舉辦「為水走5公里」健走活動，邀約50位新潤之友一同參與，希望能藉由健走與闖關活動能喚起各位對環境永續的意識。

To raise awareness about the value of water resources, Shin Ruenn partnered with the Dandelion Hope Foundation to host the "5K Walk for Water" event. Fifty friends of Shin Ruenn were invited to participate in this meaningful activity. Through the walkathon and checkpoint challenges, the event aimed to inspire participants to embrace a deeper understanding of environmental sustainability.



蒲公英希望基金會 Dandelion Hope Foundation

此次的志工活動不只是陪伴這些特教班學生認識蔬果，而是大家一起學習、互相成長。在園長的帶領之下，用五感體驗蒲公英希望基地裡多樣性植物，一起與大自然互動，與同學在互動中找到學習的樂趣。

This volunteer activity went beyond simply introducing special education students to fruits and vegetables; it was an opportunity for everyone to learn and grow together. Guided by the principal, participants engaged their five senses to explore the diverse plant life at the Dandelion Hope Center. Through interactions with nature and their peers, the students discovered the joy of learning in a hands-on and collaborative environment.





瑞信兒童醫療基金會

Raising Foundation

今年第二次參加瑞信兒童公益路跑，上一次邀請了將近200位的新潤之友共襄盛舉，而今年再度參與路跑活動同樣來了188位的粉絲熱情參加，降雨機率60%的週日感謝188位新潤之友依然不懼風雨如期出席。

This year marks Shin Ruenn's second participation in the Raising Foundation's charity run event. Last time, nearly 200 friends of Shin Ruenn joined the event, and this year, an enthusiastic 188 fans participated once again. Despite a 60% chance of rain on Sunday, we are deeply grateful to the 188 friends of Shin Ruenn who braved the weather and attended as planned.





關愛基金會

Harmony Home Foundation Taiwan

以往服務對象有長輩、有青少年、有視障者，第一次與小小朋友相處，這些小朋友都是失依兒童，了解家園裡的小朋友各種故事，便有了惻隱之心，希望社會大眾能多關注這些弱勢兒童並給予更多的幫助。

In the past, our service recipients included seniors, teenagers, and visually impaired individuals. This was our first time engaging with young children, all of whom are orphaned. Learning about the unique stories of these children in the home evoked a deep sense of compassion. We hope society will pay more attention to these disadvantaged children and provide them with greater support and care.



等家寶寶社會福利協會 Greenboybaby

先前參與南港關愛之子家園的孩童陪伴，瞭解到育幼院孩童食用的蔬果都來自等家寶寶的安心蔬果配送。

During our previous visits to accompany the children at Nangang Harmony Home, we learned that the fruits and vegetables consumed by the children come from the safe produce delivery service provided by "Greenboybaby."

第三次來到等家寶寶包裝蔬果，颱風過後育幼院的物資應是最短缺的，快速把無毒農的蔬果打包好派送各地育幼院，讓小朋友們吃上安心無毒的蔬果

On our third visit to assist with packaging produce for Greenboybaby, we recognized the urgent need for supplies following the typhoon. With efficiency, we packed the non-toxic, fresh produce to be distributed to various orphanages, ensuring that the children could enjoy safe and wholesome fruits and vegetables.



弘道老人福利基金會

Hondao Senior Citizen's Welfare Foundation

弘道老人福利基金會每年歲末發起的「寒冬助老 刻不容緩」獨居弱勢長輩關懷計畫，在新潤志工的陪伴下，享用豐盛年菜，一系列的活動讓阿公阿嬤感受到團聚的歡樂、節慶的溫暖。

The Hondao Senior Citizen's Welfare Foundation's annual year-end initiative, "Urgent Winter Assistance for Elderly in Need," focuses on supporting disadvantaged and solitary seniors. Accompanied by Shin Ruenn volunteers, these seniors enjoyed a hearty New Year's feast. A series of activities brought the grandpas and grandmas the joy of togetherness and the warmth of the festive season.

未來展望

Future Outlook

1. 預定完工年度及自佔總銷金額

Expected Year of Completion and Ratio to the Total Sales Amount

2. 2025銷售建案

Pre-sale Projects in 2025

營運策略 Future Strategy

土地開發

Land Development

- 合建 Joint development
- 危老
Renovations for Dangerous/
Old Buildings
- 都更
Urban Regeneration

目標客群

Target group

- 剛性需求
Rigid demand
- 首購族群
First-time homebuyer
- 換屋族群
Provide upscale properties to
aspirational middle class in
Taiwan

銷售策略

Strategy

以客戶的角度為出發，將產品更為優化，提升品牌忠誠度。

Starting from the customer's perspective, we will optimize our products and enhance brand loyalty.

企業社會責任

ESG

取之社會，用之社會的理念，送暖捐助給每個建案的在地弱勢團體，持續關懷公益

With the concept of what is taken from society is given back to society, we extend warmth and support to local disadvantaged groups involved in our projects, while maintaining a steadfast commitment to public welfare initiatives.

預定完工年度及自佔總銷金額

Expected Year of Completion and Ratio to the Total Sales Amount

縣市 County/City	案名 Project Name	113年/2024	114年/2025	115年/2026	116年/2027	117年/2028
		(如為共同投資僅列新潤興業部分) (If the listing is a joint venture, only Shinruenn's profit is listed)				
新北市 泰山區 Taishan Dist, New Taipei City	新潤A5 (Shinruenn A5)	25.92				
新北市 淡水區 Danshui Dist, New Taipei City	新潤心苑 (The Fancy World)	9.55				
桃園市 蘆竹區 Luzhu Dist, Taoyuan City	新潤麗蒔 (Boutique Casa)	15.18				
新北市 新莊區 Xinzhuang Dist, New Taipei City	新知商辦大樓 (xinzhi commercial)	29.9				
台北市 南港區 Nangang Dist, Taipei City	擎天森林 (Sky Forest)		54.6			
新北市 土城區 Tucheng Dist, New Taipei City	新潤青樺 (Seasons Park)		39			
新北市 林口區 Linkou Dist, New Taipei City	新潤Double (Shinruenn Double)		39.66			
新北市 新莊區 Xinzhuang Dist, New Taipei City	森中央(MORI CENTRAL TOWER)			21		
新北市 板橋區 Banqiao Dist, New Taipei City	新潤RIVER ONE (RIVER ONE)			38		
桃園市 中壢區 Zhongli Dist, Taoyuan City	新潤潤青 (RUN FOR YOUNG)			14		
台北市 北投區 Beitou Dist, Taipei City	士科大院. (La moon city spirit)				77	
桃園市 中壢區 Zhongli Dist, Taoyuan City	中運段 (chungyun section)					16.4
合併年度總銷 Consolidated Total Amount of the Year		80.55	133.26	73	77	16.4

2025銷售個案

Pre-sale Projects in 2025



建案名稱 Projects	士科大院. La Moon City Spirit	新潤潤青 RUN FOR YOUNG	力行段 Lixing Section
區域 Area	台北市北投區 Beitou Dist, Taipei City	桃園市中壢區 Zhongli Dist, Taoyuan City	新北市林口區 Linkou Dist, New Taipei City
戶數 Total units	256戶 256 Residential Units	162戶 162 Residential Units	804戶 804 Residential Units
總銷金額(億元) Total amount in sales(NTD 100 million) 僅列新潤自佔總銷 Only Shinruenn's profit is listed	77	14	45.2
合計(億元) Total amount (NTD 100 million)	136.2		

都更開發案

Urban Renewal Development Project

區域 Area	段別 Section code	基地面積 Base Area	階段 Phase	程序 Procedure
新北市板橋區 Banqiao Dist, New Taipei City	江子翠段第一崁小段 First Kan Subsection of Jiangzicui Section	1612坪 1612 ping	擬訂事業計畫審議階段 Business Plan Drafting and Review	公開展覽及公辦公聽會 Public display and public hearing meetings
新北市中和區 Zhonghe Dist, New Taipei City	大華段 Dahua Section	821坪 821 ping	擬訂事業計畫審議階段 Business Plan Drafting and Review	第一次專案小組 First task force
台北市大同區 Datong District, Taipei City	玉泉段 Yuquan Section	530.89坪 530.89 ping	擬訂事業計畫審議階段 Business Plan Drafting and Review	送審中 Submit for review



Q&A

謝謝指教

End of Presentation.
Thank You!



官網 | OFFICIAL SITE



臉書粉專 | FACEBOOK PAGE



YOUTUBE



INSTAGRAM